

SECTION B-B

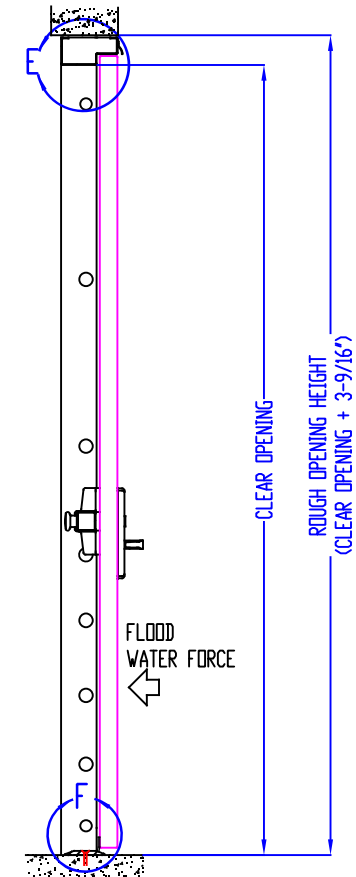

SECTION A-A

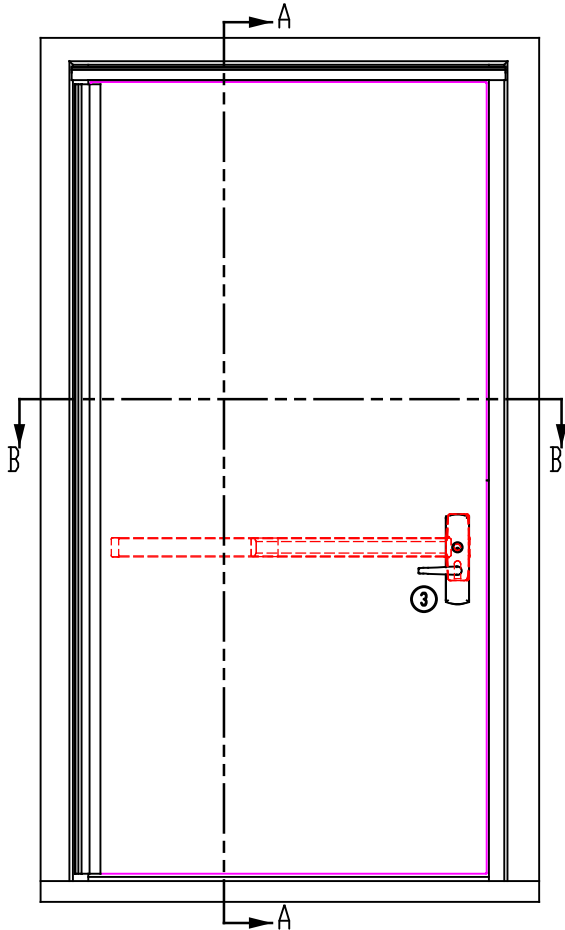
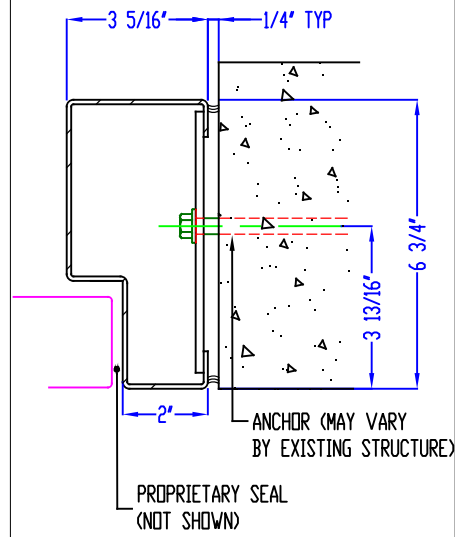

DETAIL C  
JAMB DETAIL ②④

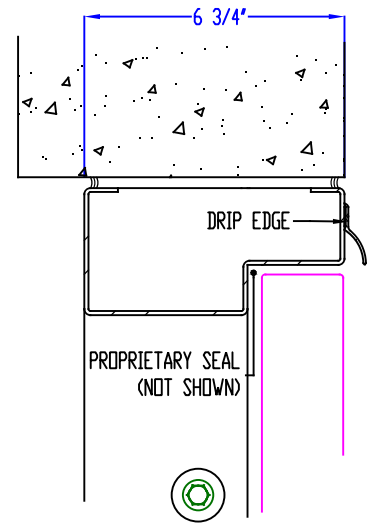

DETAIL E  
HEAD DETAIL ②④

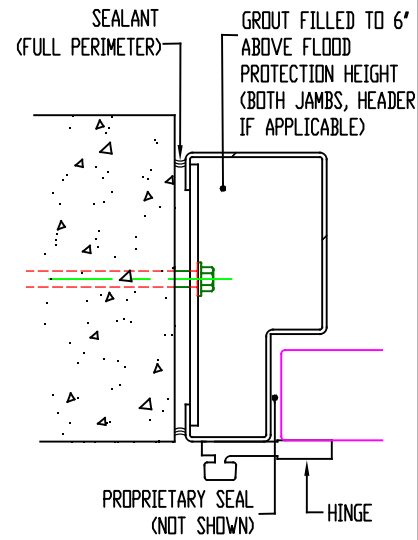

DETAIL D  
JAMB DETAIL ②④

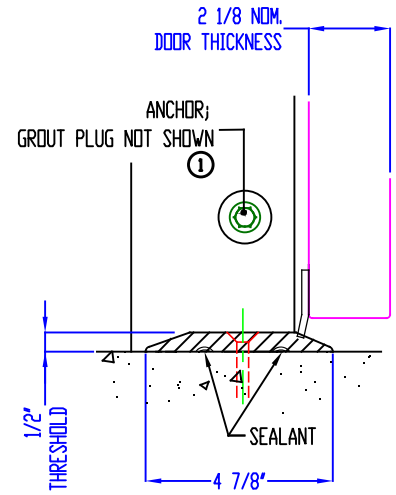

DETAIL F  
SILL DETAIL

**PD-520 PEDESTRIAN FLOOD DOOR**

PROPRIETARY AND CONFIDENTIAL DRAWINGS ARE EXCLUSIVE PROPERTY OF PRODUCTION SPECIALTIES CORPORATION, dba PS DOORS AND CANNOT BE USED IN WHOLE OR PART WITHOUT WRITTEN CONSENT © 2017 PS DOORS ALL RIGHTS RESERVED

- ① LOCATION AND QUANTITY OF ANCHORS TBD BASED ON LOADING
- ② DESIGN SHOWN REQUIRES STRUCTURE TO BE A MINIMUM OF 8" GROUT FILLED CMU OR 3000 PSI CIP; CONTACT PS DOORS FOR DEVIATIONS
- ③ STANDARD LATCHING HARDWARE; VON DUPRIN 98L US28 /996L R&V
- ④ FLOOD LOADS ON DOOR ASSEMBLY ARE TRANSFERRED TO BUILDING STRUCTURE

MODEL: PD-520

DATE: 05/19/2017

**REFERENCE DRAWING  
NOT FOR CONSTRUCTION**

SCALE: NTS

SHEET #: 1 OF 1

DWG BY: PS DOORS

REV: C

**PS DOORS**  
 1150 S 48th ST  
 GRAND FORKS, ND 58201  
 PH. 701-746-4519  
 FAX 701-746-8340  
 psdoors.com